

MinimumRC™

Spitfire Assembly Instructions

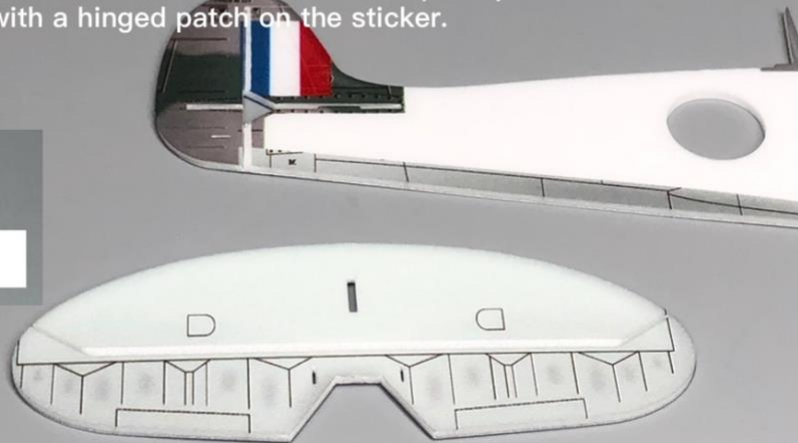

- 1 Cut a bevel at the rudder and elevator engraved lines.
P.S.: the rudder surface can also be cut off completely
and connected with a hinged patch on the sticker.



- 2 After cutting a bevel at the score line, the rudder can
move in both directions.



3

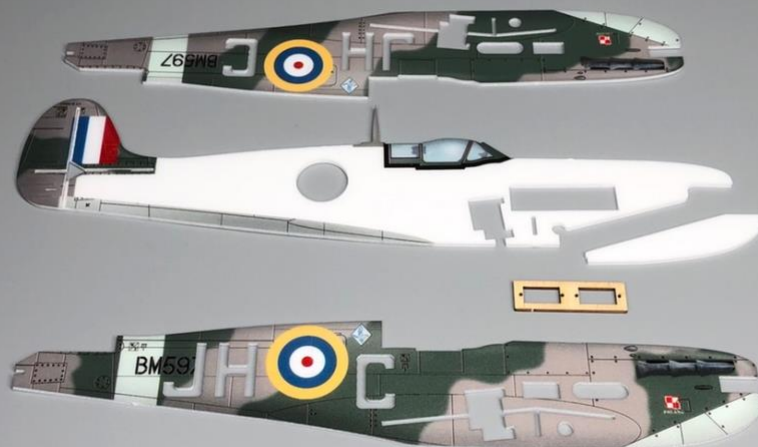

4

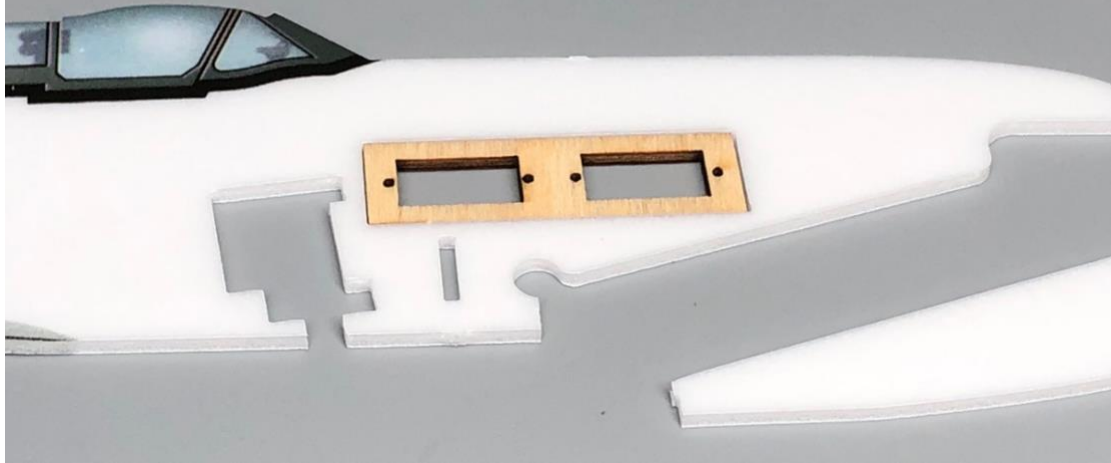

- 5 Fix the motor, and the motor wire should pass through the hole on the left side of the fuselage. Install the bottom pad of the fuselage.

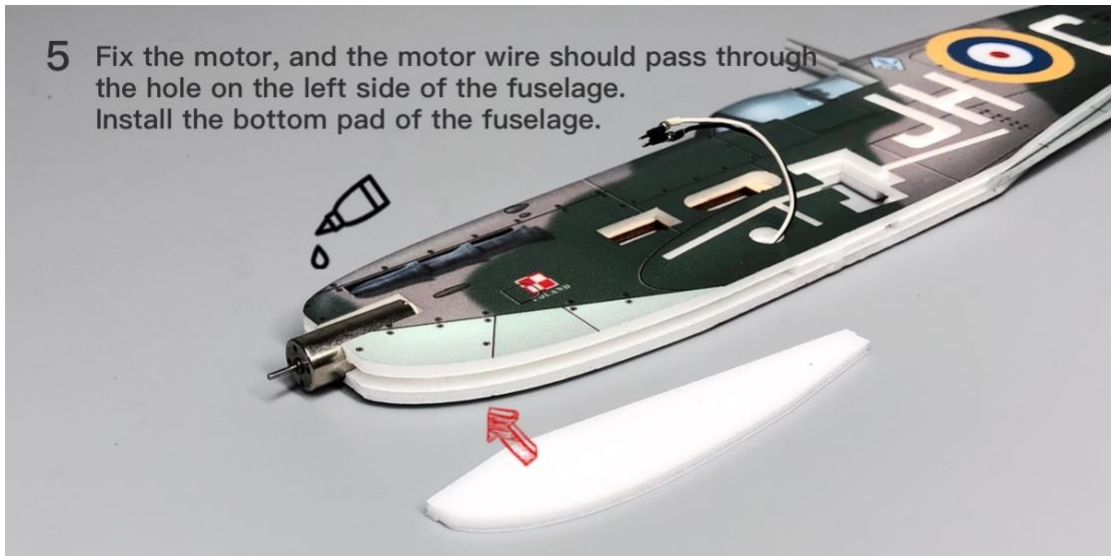

- 6 Cut off the servo fixing piece and fix the aileron servo with glue.



7 Use sticker to cover the servo.



8



9

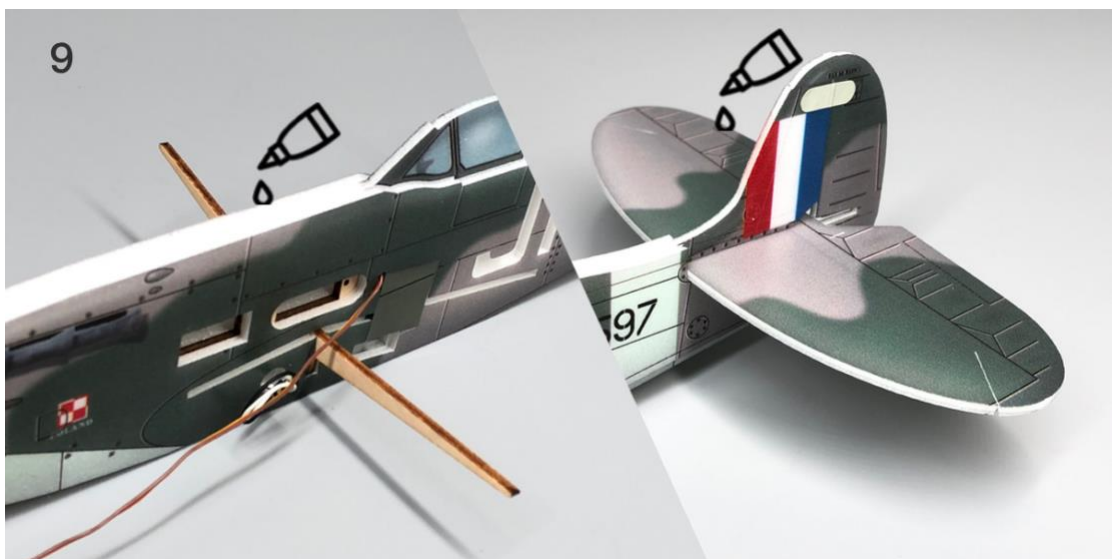

- 10 Cut a bevel along the aileron engraving line so that the aileron can move up and down.

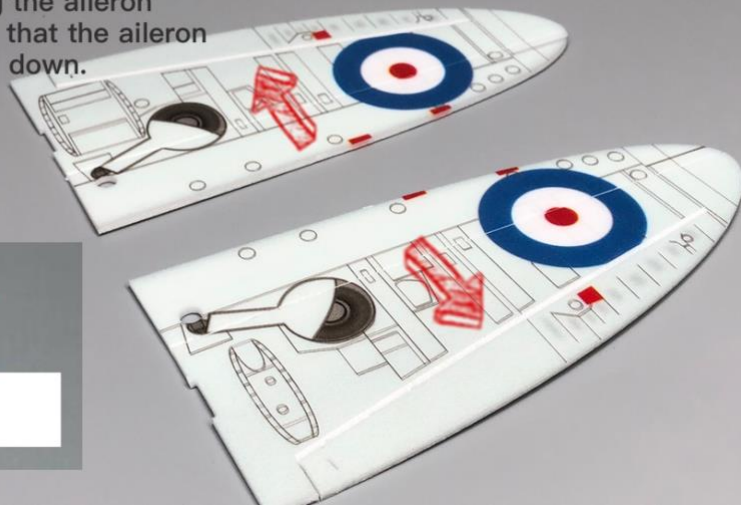

- 11 After cutting the bevel along the aileron score line, the aileron can move downward.



- 12 Bend the wings down the center engraved line. Adhere the wings to the fuselage.



13

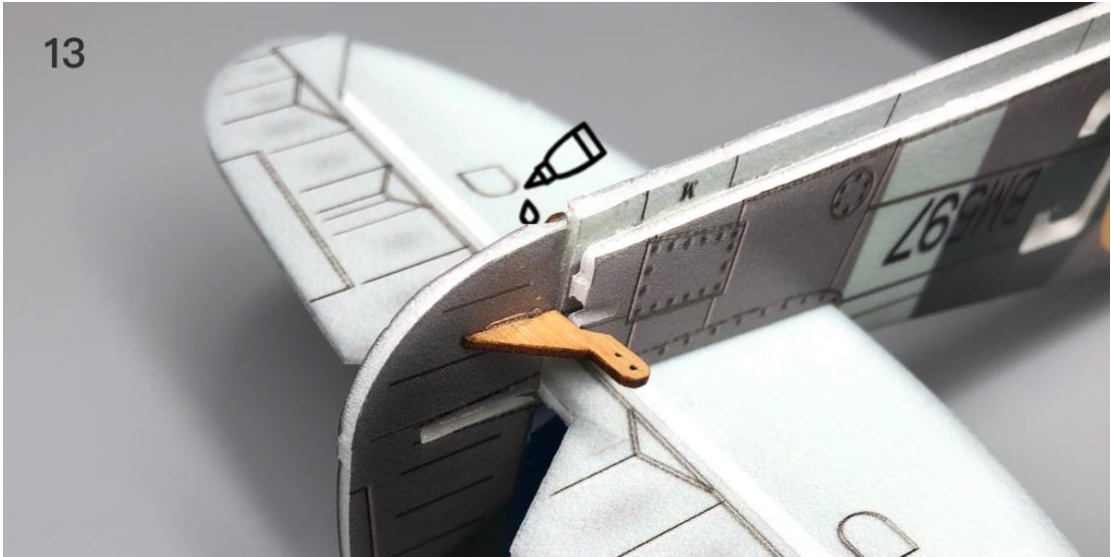

14

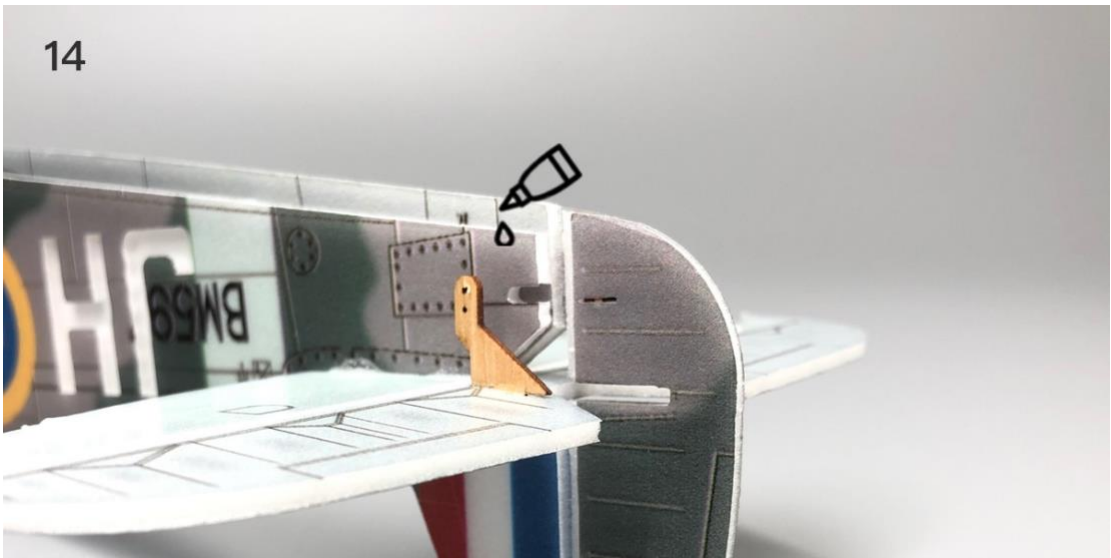

15

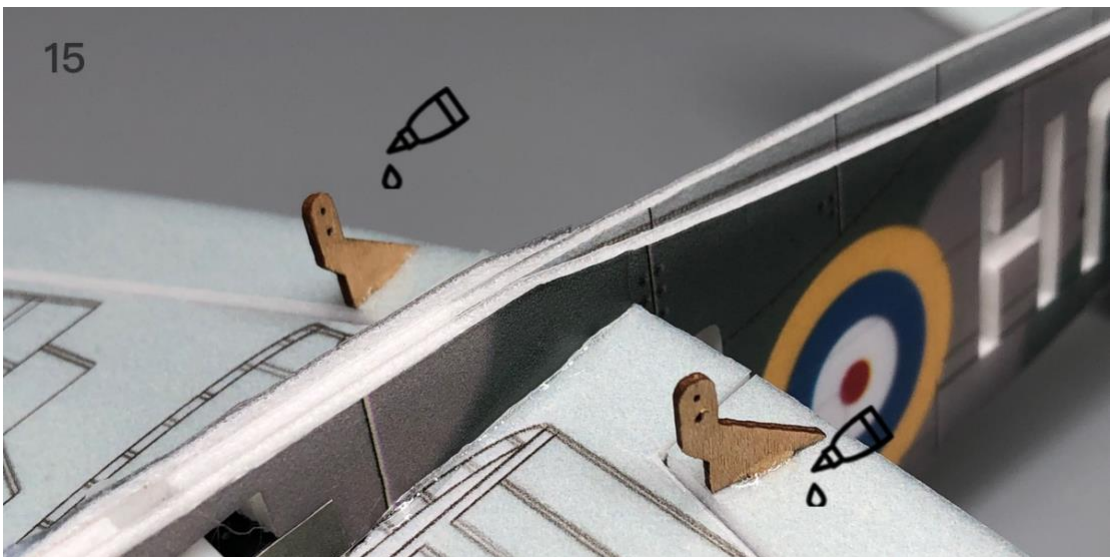

16 Install the tail servos.

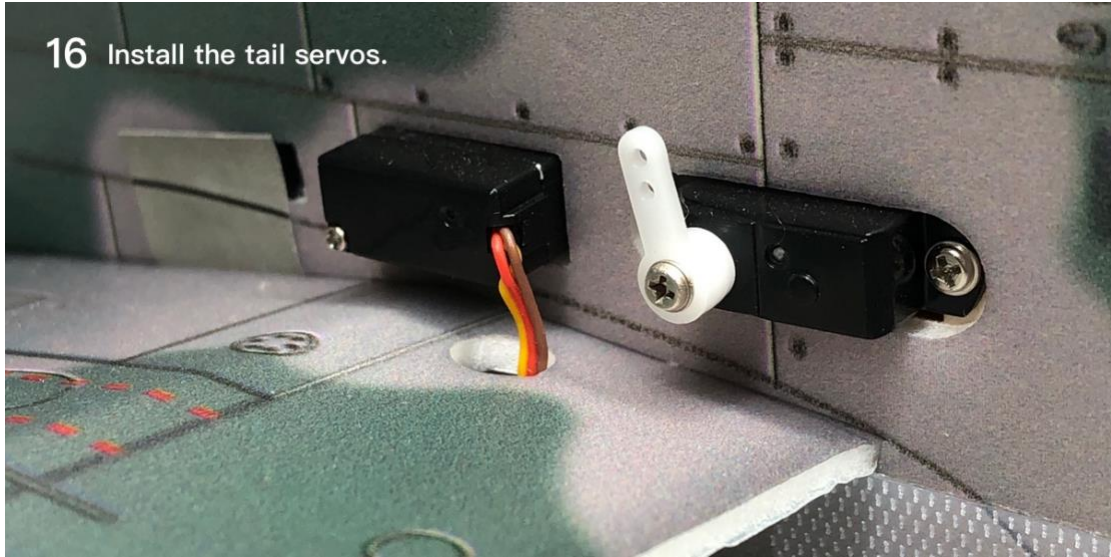

17 Connecting aileron rods with heat shrink tube (length 8mm) .



18



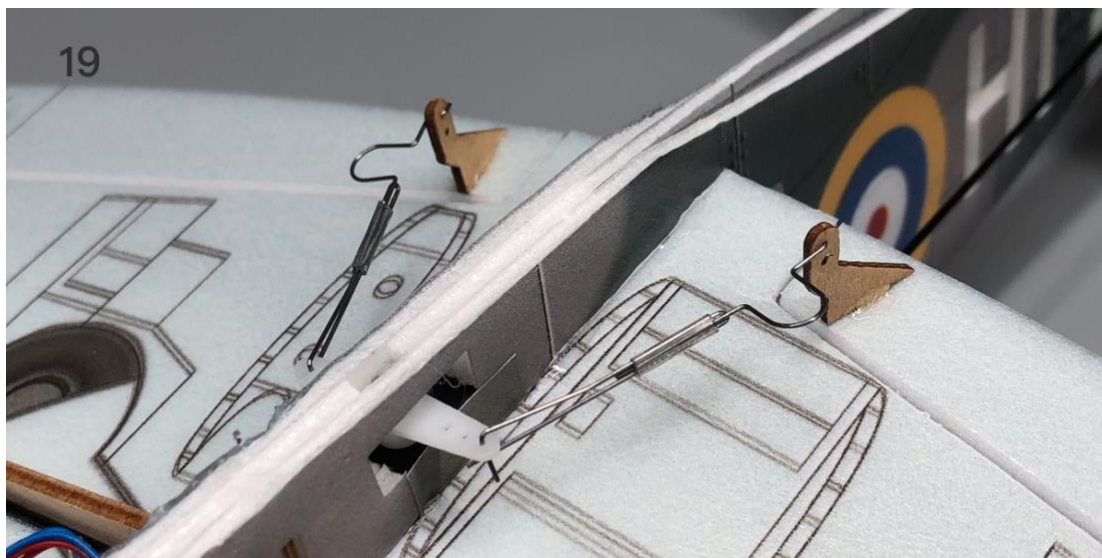

20 Use heat shrink tube to connect the elevator rod.
(The length of the carbon rod needs to be cut
according to actual needs)



21



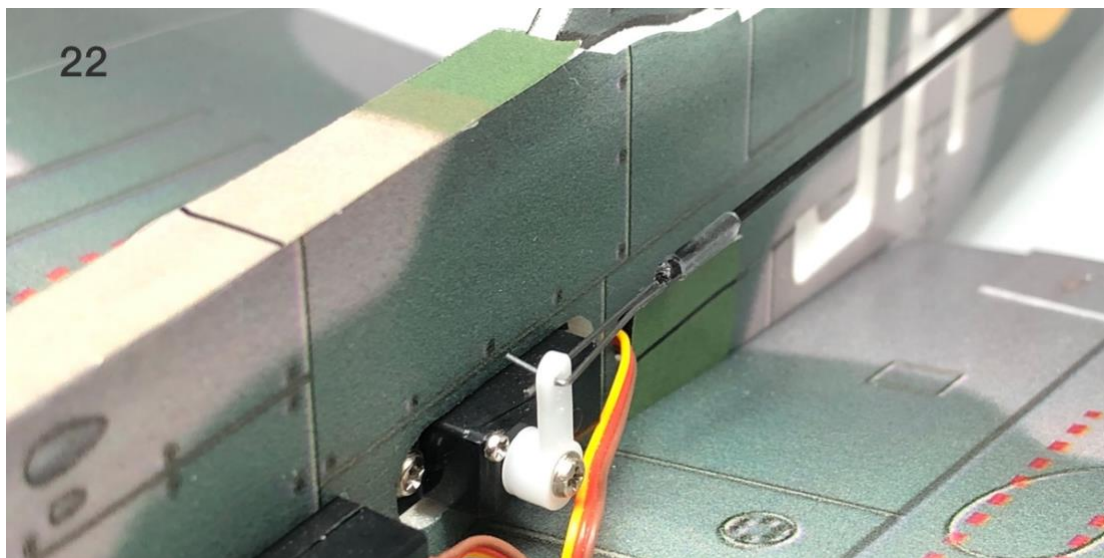

25 Attach the receiver with Velcro.



26 Attach the battery with Velcro.



27 Paste stickers. Assembly complete!



First test flight

- The center of gravity is 10 mm from the leading edge of the wing. Move the battery forward and backward to adjust the center of gravity.
- The range of elevator, rudder and aileron movement is 5 mm for each side. Please adjust the rudder surface to the level before flight test.

Explore the ultimate possibility of RC aviation

MinimumRC.com