

# Installation diagram

## Component diagram

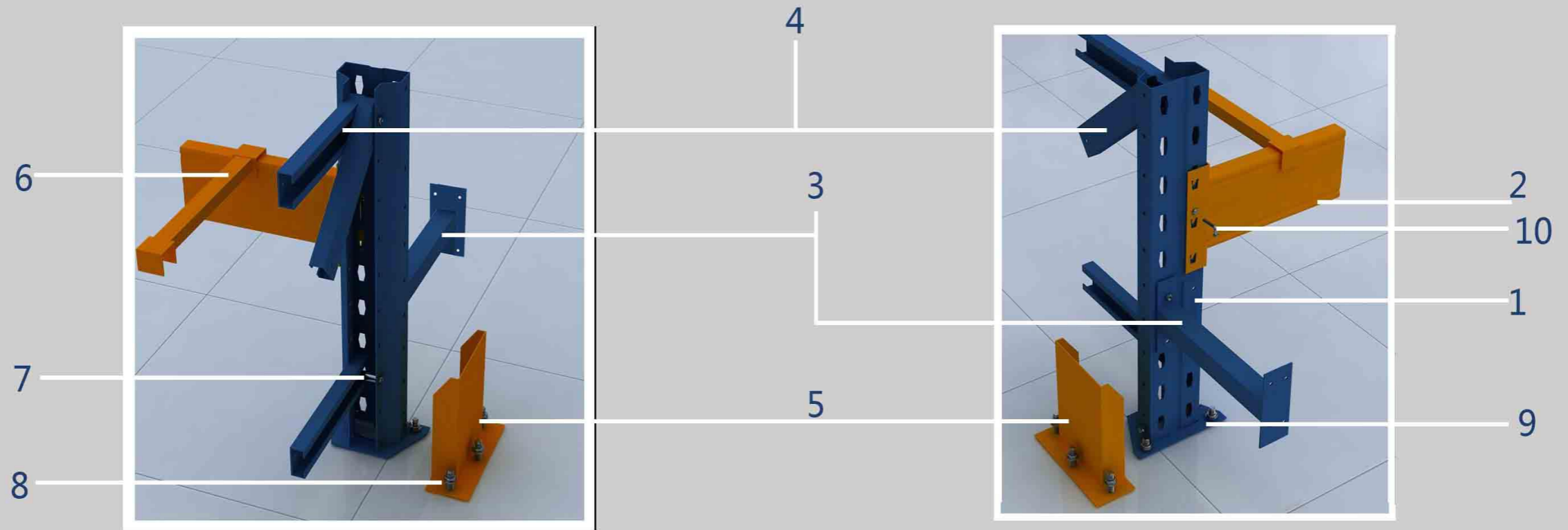

1	Upright
2	Beam
3	Connection Rod/Row spacer
4	Horizontal/Diagonal bracing
5	Protector
6	Beam connection/Pallet support
7	Bracing Pad
8	Expansion bolt & nut
9	Foot plate
10	Safety Pin



## Installation process diagram



### FRAME INSTALLATION

- 1 Take out two pieces upright, place in order.
- 2 Take out horizontal and diagonal bracing (The long one is diagonal bracing, the shorter one is horizontal bracing), Let the horizontal bracing aim at screw hole closest to foot (Opening is upward)
- 3 Install the bracing pad
- 4 Penetrate the bolt and twist the nut (loose)
- 5 Put the other end of horizontal bracing in the same position of the other upright, put the diagonal bracing in this upright aim at the screw hole (opening is downward), penetrate the bolt and nut (loose)
- 6 Put the other end of diagonal bracing aim at upper screw hole in the other upright, take out a diagonal bracing, penetrate the bolt and switch the nut. All the diagonal bracings would be installed like this.
- 7 Once installation on the top screw hole, take out one horizontal bracing, install together with diagonal bracing.
- 8 Install the bracing pad on the other end, then install in the upright.
- 9 Install the footplate with upright.
- 10 All the frames would be installed like this, and tighten all the bolt & nut

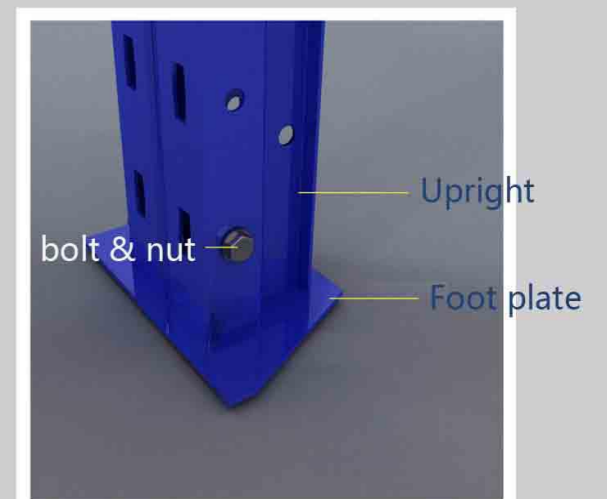

## Beam installation

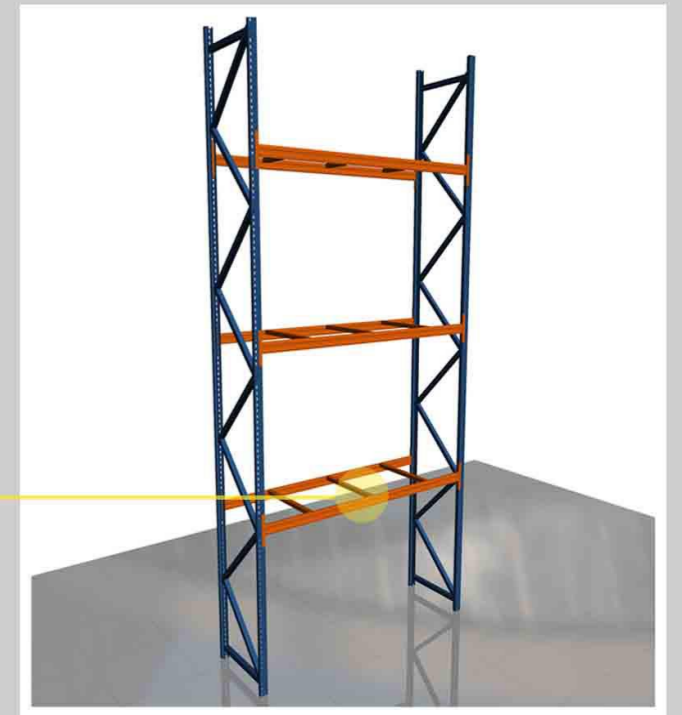
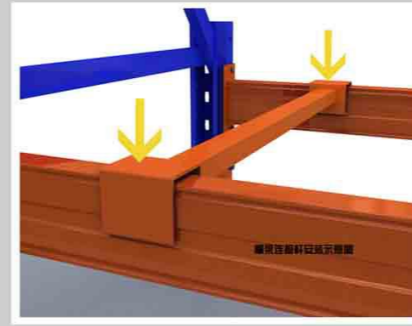
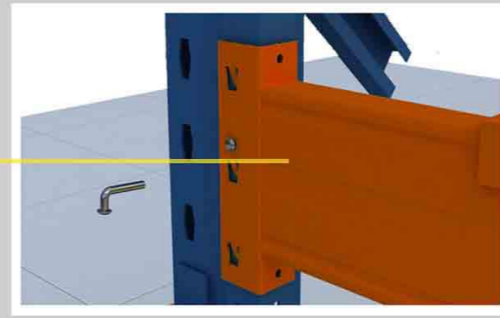
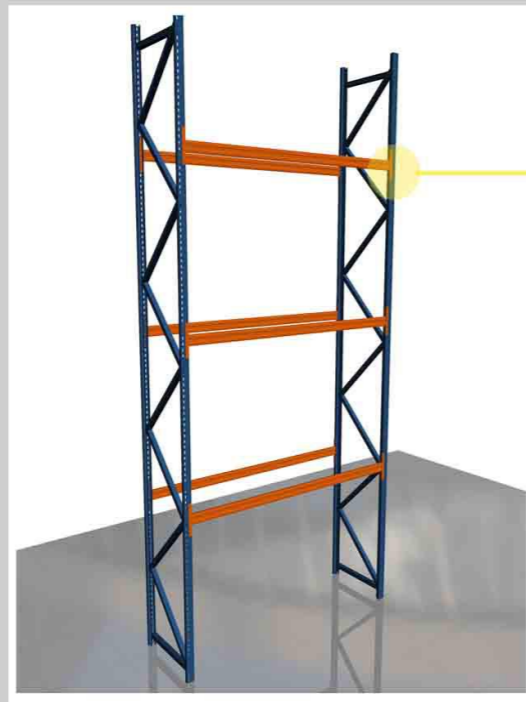
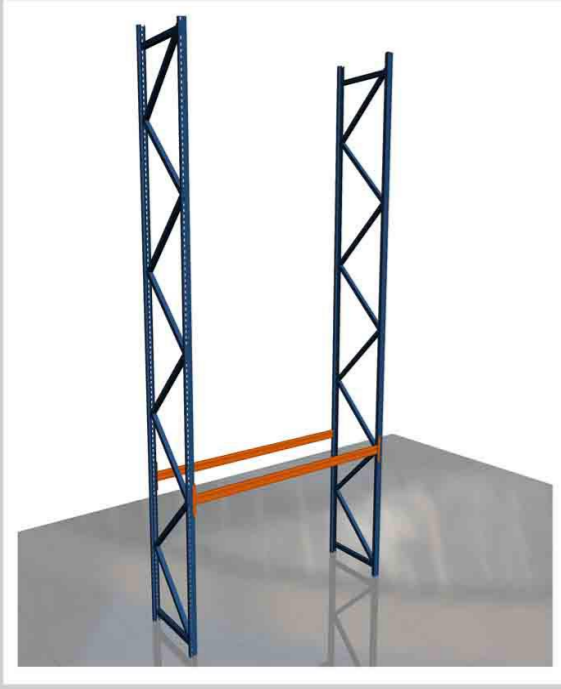

### Beam installation

- 1 Stand up two frames (foot plate down), set the beam on the frame, make sure the beam pin into the correct holes. In order to ensure the safety, one of frame could be against wall.
- 2 Install the safety pin.
- 3 Put the beam rod/Pallet support on the beam, in order to make beautiful, each one had better in same order.

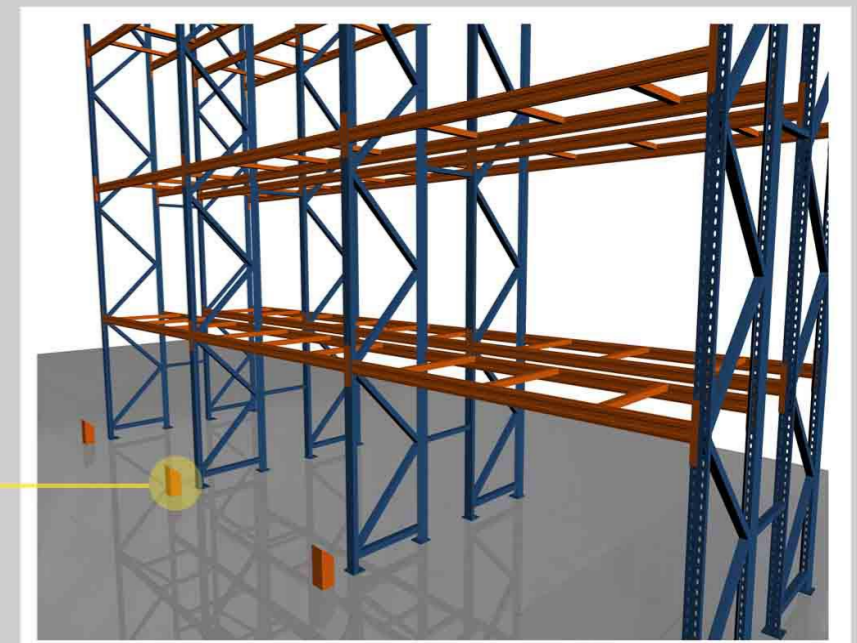
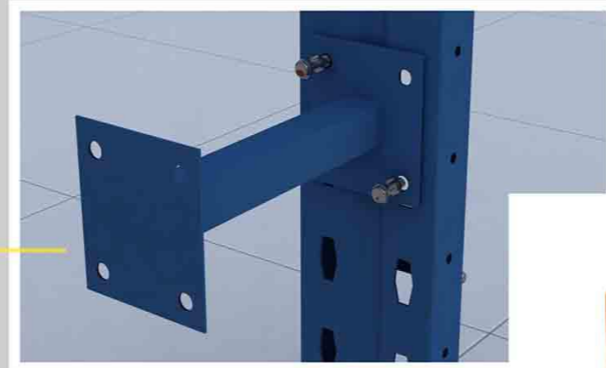
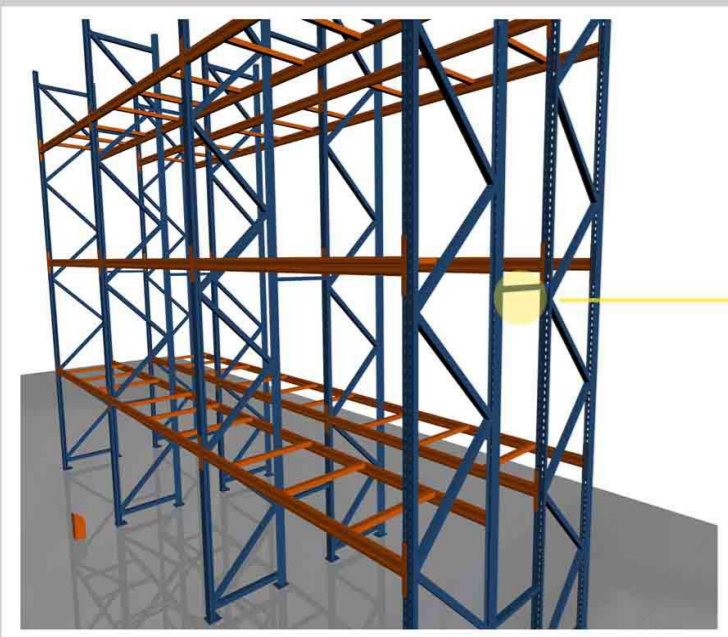

### Adder installation.

- 1 The beams of adder are installed on the near frame.
- 2 According to drawing and actual requirement, place the rack in order.

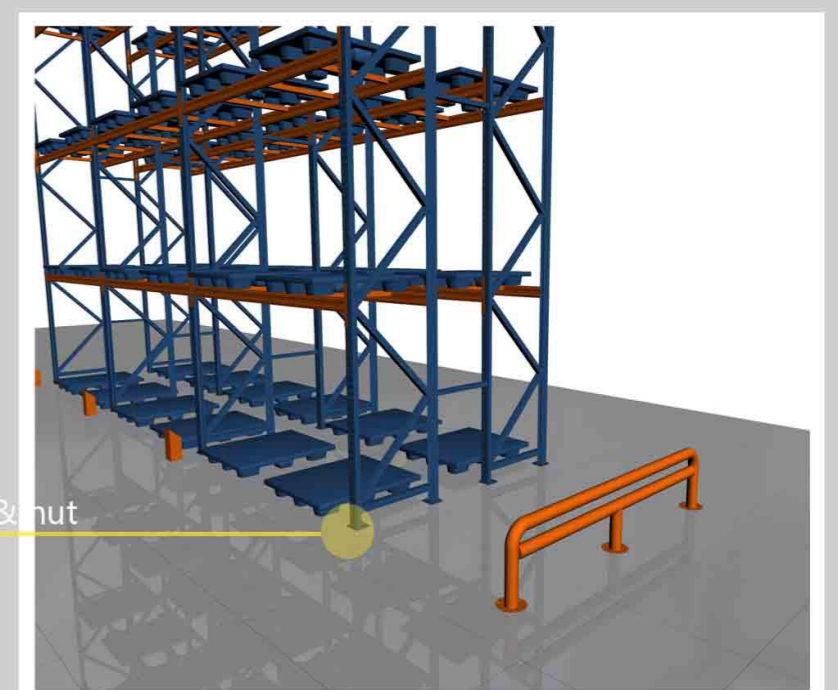
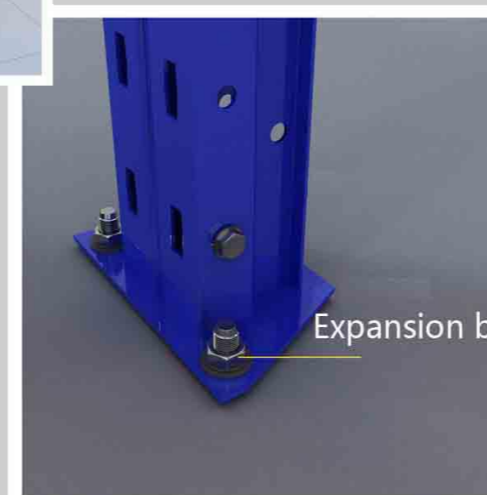
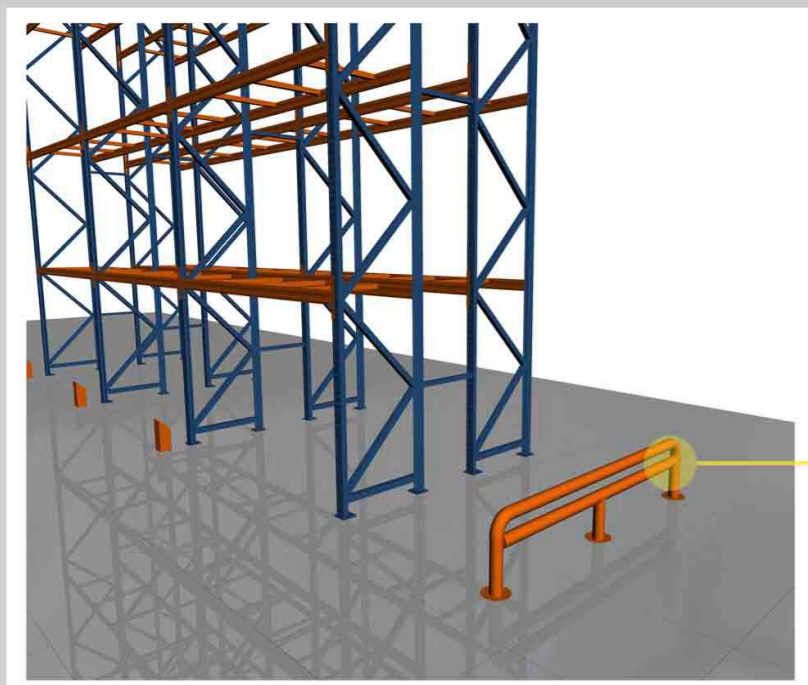

### Foot plate and protector installation

- 1 According to drawing or actual requirement, place the foot plate, protectors in order.
- 2 Drill the hole on the grounds by use of drilling machine, hammer the expansion bolt & nut, twist it tighten by spanner.

# Contact Details

- Official company name in English: Guangzhou Heda Shelves Co., Ltd.
- Official address in detail: No.183, exhibition south Rd, xingang dong Rd, Haizhu district, Guangzhou City, Guangdong Province, PR China (PC: 510335)
- Website: [www.hedastorage.com](http://www.hedastorage.com)
- Contact person and title: Faye Lee
- Email: [heda@hedastorage.com](mailto:heda@hedastorage.com)
- Phone/Whatsapp/WeChat: +86 135 1275 1081

