

PROFESSIONAL BIOMETRIC RECOGNITION AND SOLUTIONS SUPPLIER

- Access control systems
- Attendance management systems
- Multi-Location Attendance Solution On Cloud



Face ID



Fingerprint



PIN



CARD



Combination

WDR multi person face recognition time attendance access control



TM-AI01

IP65 Waterproof
Outdoor/Indoor both
Aluminium alloy Case
5 inch HD IPS Touch
Screen

TM-AI02

LED Frame Plastic
Case Bell Button
4.3 inch IPS
Touch Screen

TM-AI03F

5 inch IPS Screen
Support Face &
Fingerprint,
Card

TM-AI08

Mifare & EM
card Both
8 inch HD IPS
Touch Screen

TM-AI07F

AI Face & Fingerprint Type
Aluminium alloy Case
5 inch HD IPS Touch
Screen

TM-AI06

Best Price Model
4.3 inch IPS Touch
Screen

TM-AI05

Both Desktop Bracket/
Wall-mounted Bracket
Screen Virtual Bell Button
5 inch HD IPS Touch
Screen

Common Features

- ◆ Support face recognition for 5 person at same time, recognition speed is $\leq 0.2s$
- ◆ Support WDR(wide dynamic range), and support face recognition under strong light, dark light and Backlight.
- ◆ Support live body face detection, prevent human photo and video
- ◆ Support TCP/IP, USB Link (WIFI Optional)
- ◆ Support QR code reader
- ◆ Support face identification with wearing mask.
- ◆ Support stranger face picture capturing within camera detection range
- ◆ Support face recognition distance adjustment for short, middle, long level.
- ◆ Screen lock setting for automatic face detection
- ◆ Professional time attendance and access control function
- ◆ Free Desktop Software, Web Cloud, and Mobile App.

Specifications

Product name	AI Dynamic Face Recognition Time Attendance Access Control Terminal
Multiple Languages	English and other 16 types
Keypad	Touch keypad
Operation system	LINUX 3.10
CPU,NPU	1.2G Dual-Core ARM Cortex-A7, 600G (0.6T)
RAM	256MB DDR3
ROM	eMMC Flash 4GB
Binocular camera	200W Colorful WDR+200W Infrared live camera
Logs capacity	500000
Face Registration	Local operation: Enroll face with machine, import user photo with U disk Software operation: Import user photo to software, capture user photo with camera
Verification	Dynamic face recognition, password, ID/IC card optional
Face capacity	5000 (50000 optional)
Card Capacity	5000 (50000 optional), ID Card Standard, IC Card Optional
Password Capacity	5000 (50000 optional)
Face Recognition Accuracy	99.70%
Working temperature	-15°C~+45°C (storage temperature -40°C~+65°C) ,
Working humidity	20%~90% (storage humidity 20%~90±2%) ,
stand-by current	310mA
Working current	520mA
Management Software	DC12V
Installation	Standard: Wall mount, desktop stand; Optional: bracket for turnstile, floor stand

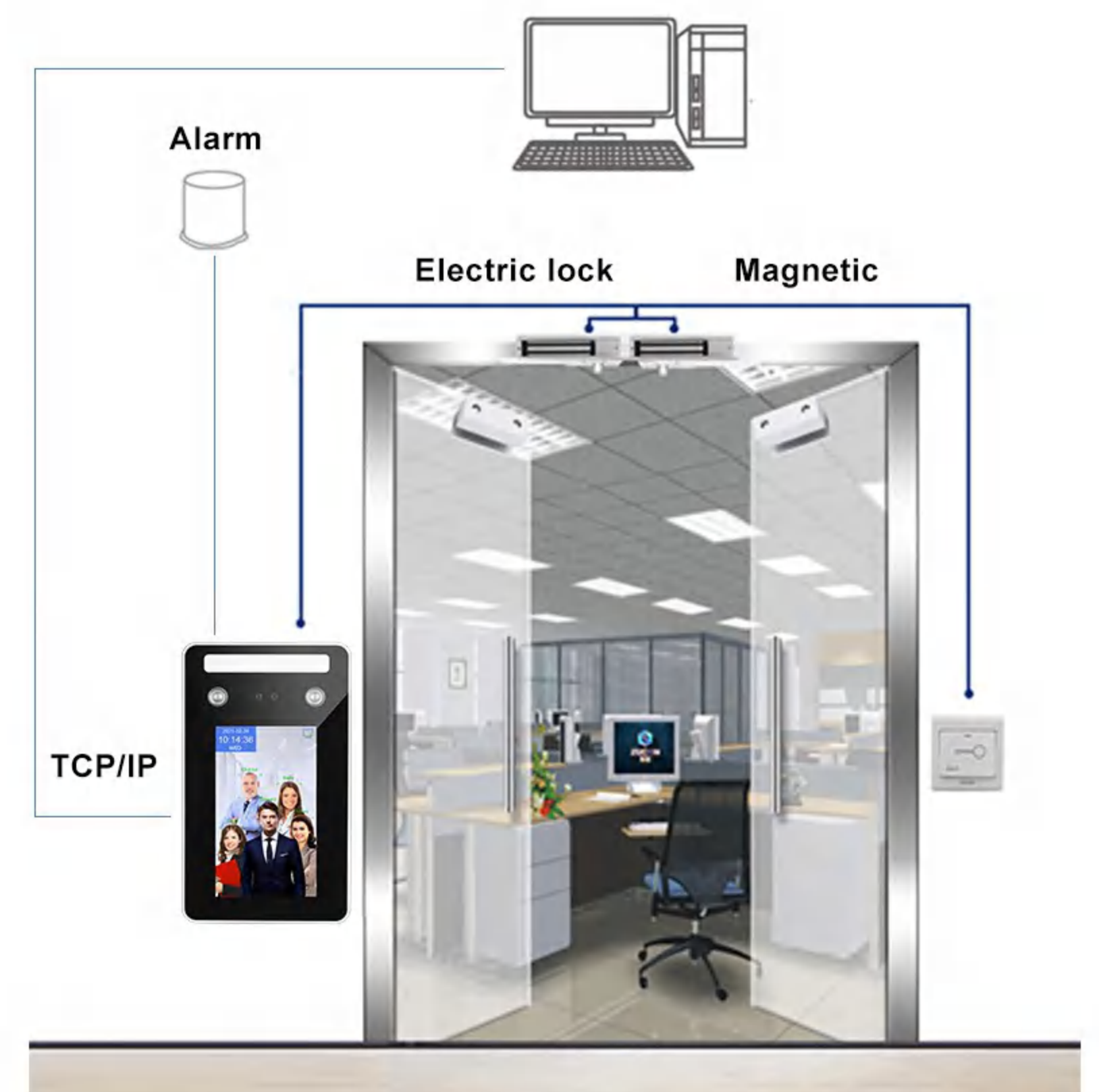

New Generation AI Face Device Software

(Including Desktop Software, Web-based Software, And Mobile App)

Multi Location Attendance and Access Control Solutions On Cloud



Face、Fingerprint、Card Time Attendance



TM-F610

TM-F650

TM-F620

TM-F630

TM-F6000

TM-F661

TM-F850

Different Case designs for your Option

Face & Fingerprint Access Control and Time Attendance Management Systems

Common Features

- ◆ Multiple identification: face, fingerprint, card and password together.
- ◆ Double camera for accurate verification.
- ◆ Wiegand in&out to combine with a third party device.
- ◆ Standard TCP/IP, RS485, USB for communication with computer and server together.
- ◆ Voice indicator for user-friendly experience.
- ◆ Functional camera for using at night.
- ◆ Facial Recognition Fingerprint Access Control Time Attendance

Specifications

Working	Network
Identification Style	Face, fingerprint, card, password
Identification Speed	<1 sec
FAR	<0.01
FAR	<0.0001
Face Capacity	1000 (Auto-learn)
Fingerprint Capacity	3000
Card Capacity	3000
Password Capacity	3000
Record Capacity	200,000
Display	2.8 TFT Color Screen
Language	English/Spanish/Turkish/Arabic/Thai/Persian and so on
Communication	TCP/IP/USB
Humidity	20%-60%
Temperature	0°C-40°C
Access control	Simple access control function for door open/close control
Output	Electric Lock
Voice	Boom, Dual LED
Power Supply	DC9V
Software	Free

EU Green Pass Reader & Biometric Access control Terminal

EU Digital Green Pass QR Code Scanner Solution



GP08L

- Support EU Health Code Recognition
- Door Access Cont
- Alarm for invalid code
- Multi language support English, Italian, Spanish, French, German, Portuguese, etc
- Body temperature detection
- Mask detection
- **8.0 Inch IPS Touch Screen**
HD 800*1280
- 200W pixel WDR wide dynamic

Display message

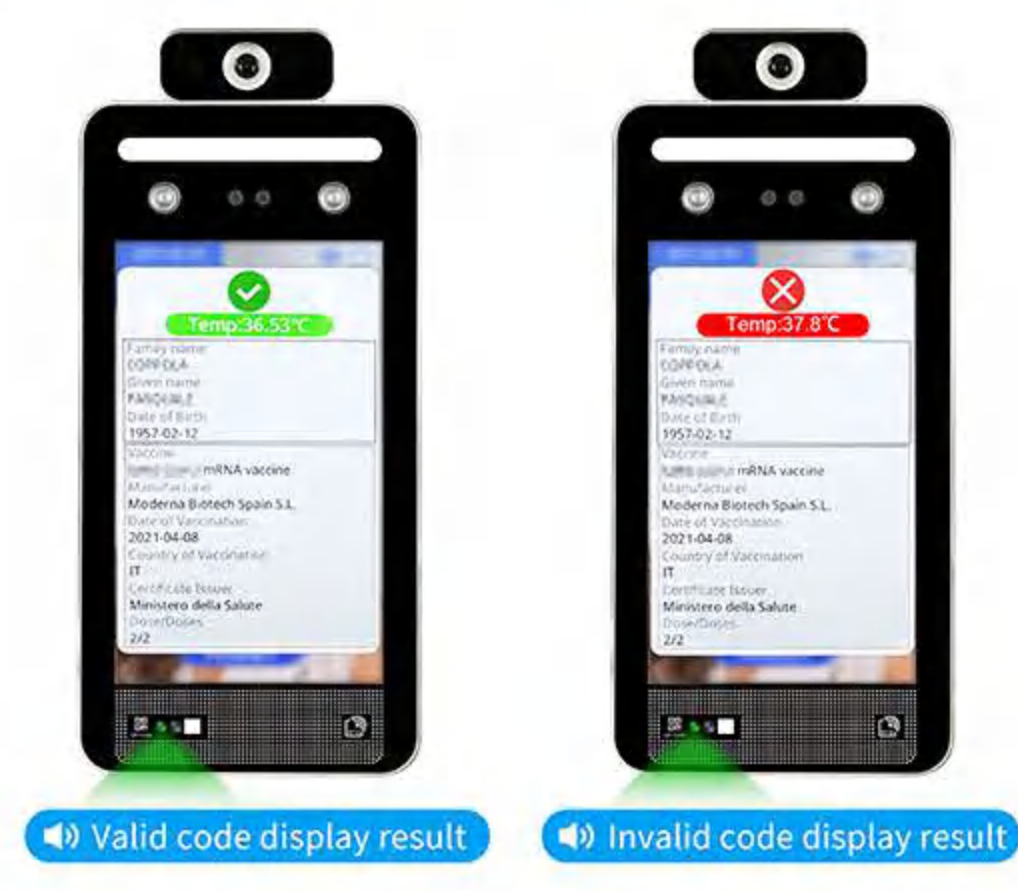

GP05L

- Support EU Health Code Recognition
- Door Access Control
- Alarm for invalid code
- Multi language support English, Italian, Spanish, French, German, Portuguese, etc
- Body temperature detection
- Mask detection
- **5.0 Inch IPS Touch Screen**
HD 720*1280
- 200W pixel WDR wide dynamic

Scan EU COVXX Certificate



GP05LN

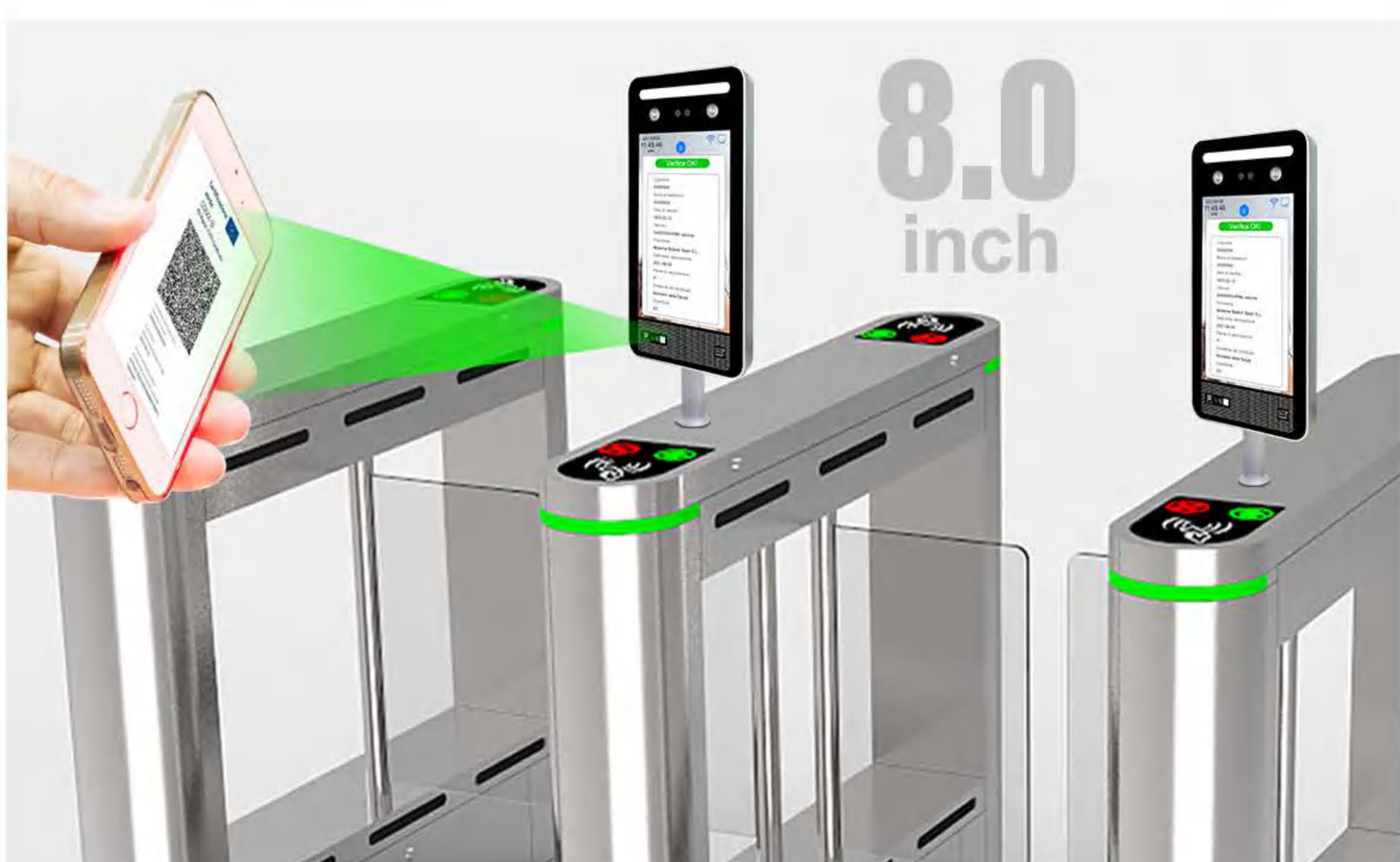
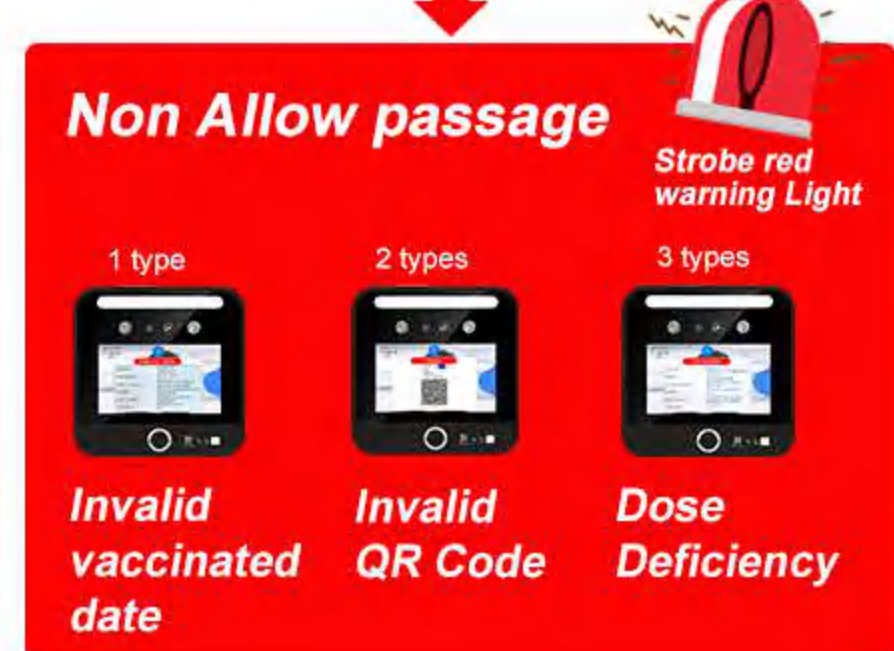
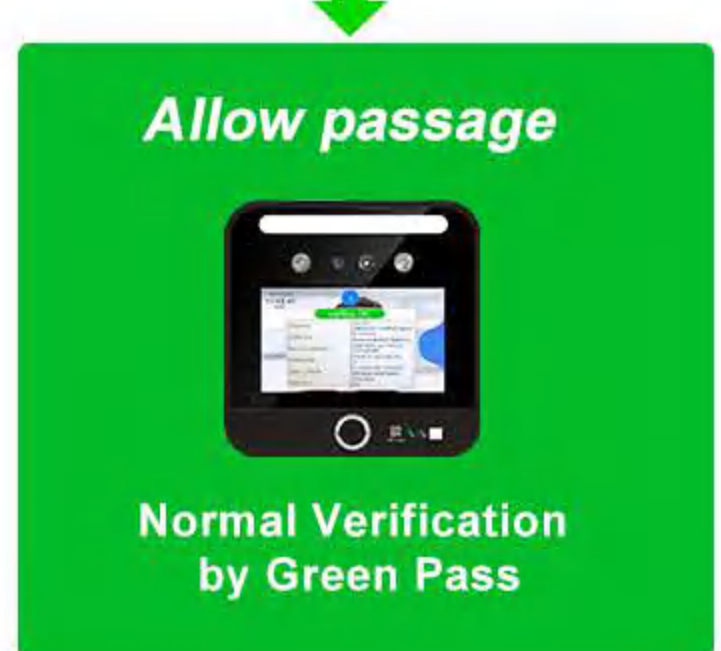

GP08LN

- Display message
- Name
 - Date of birth
 - Number in a series of doses
 - The overall number of doses in the series
 - Date of vaccination
 - Member state or third country in which the vaccine was administered
 - Certificate Issuer



Anti Covid19 Products

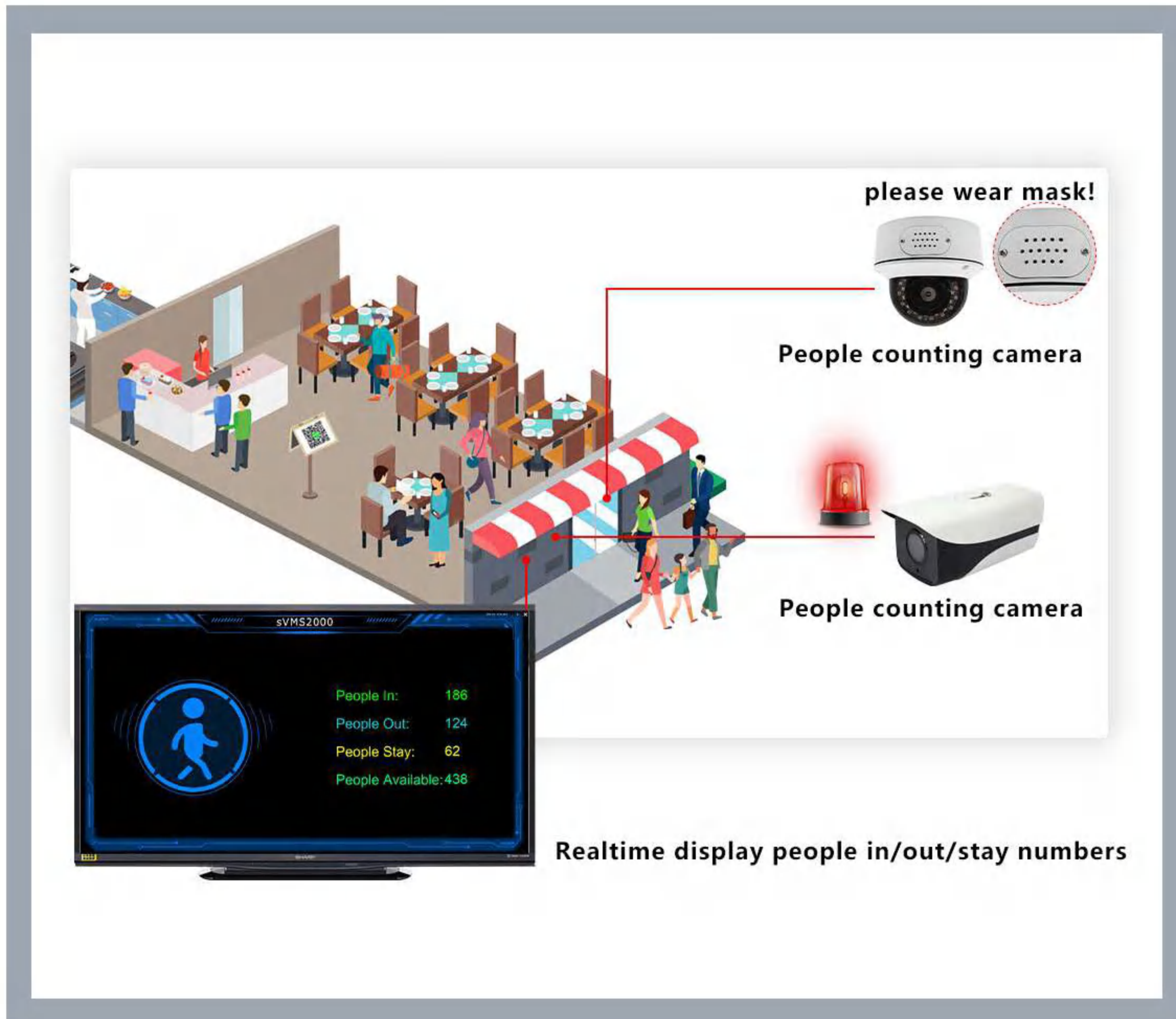

TM-PC28

COUNTING IN&OUT TO AVOID CROWDING

With the advent of the coronavirus, it has become necessary to control the maximum number of people allowed to be in a public place. Our people counting camera has multiple possibilities, not just counted how many people are in the room, but also provide relevant alerts when approaching or has reached the limit of authorized persons in accordance with government directives to avoid overcrowding.



TM-AI08T

Face Recognition&Temperature Measure Machine

- WDR wide dynamic face recognition
- Forehead body temperature detection
- Facial mask detection
- Abnormal high temperature alarm
- Time attendance&access control function
- Install on wall, turnstile, and different types stands
- With real time monitoring software
- 8 inch HD touch screen



K9 PRO

Automatic temperature measure & hand disinfection machine

- Alarm for high temperature: flashing+beeping“DIDIDI”
- LED display: temperature measure value
- Power supply: USB cable Type-C/AA battery
- Bottle capacity: 1000ml
- Mounting type: wall mount/tripod fixing/with receiving tray to put on desktop
- Automatic dispenser: Support alcohol, gel, foam
- Support Temperature unit: °C/°F
- Support voice broadcast: multi language Chinese, English, Korean, Spanish, Portuguese etc, total 15 languages
- Alarm temperature value setting: support
- Voice volume setting: support
- Alcohol volume output control: support

AI Temperature Detection Face Recognition Terminal



TM-AI03FT

5 Inch IPS Touch Screen,
With Fingerprint Sensor



TM-AI02T

4.3 Inch Touch Screen,LED Frame
Plastic Case Bell Button

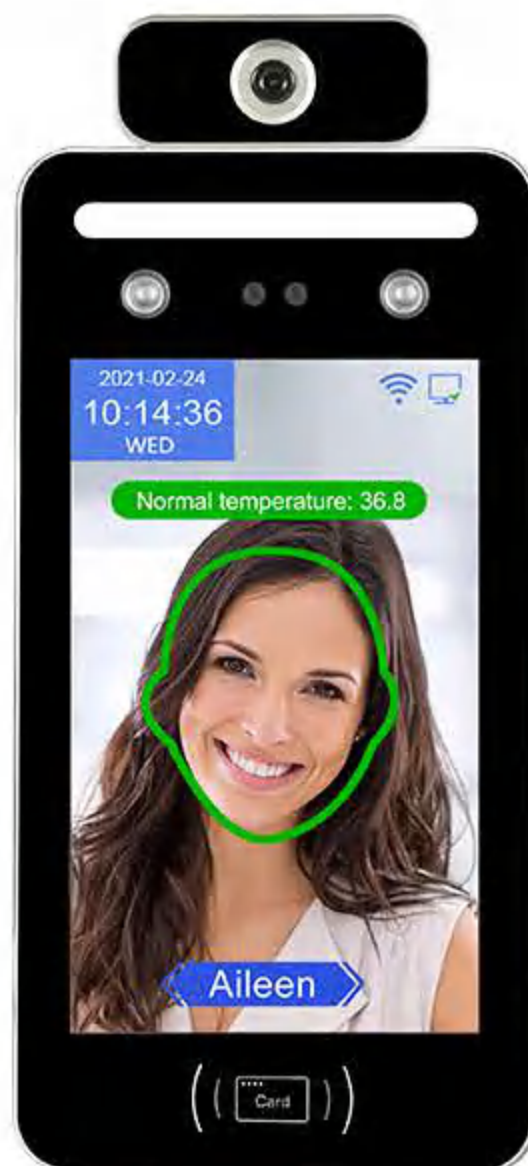

TM-AI08T

8 Inch HD IPS Touch Screen,
Mifare&EM card Both



TM-AI07FT

5 Inch HD IPS Touch Screen,
With Fingerprint Sensor

Specifications

Temperature detection distance	0.5 meter
Temperature detection Accuracy	±0.3°C
Temperature detection error	0.5°C
Temperature detection minimum unit	0.01°C
Operation system	LINUX 3.10
CPU,NPU	1.2G Dual-Core ARM Cortex-A7, 1200G (1.2T)
Binocular camera	200W Colorful WDR+200W Infrared live camera
Logs capacity	500000
Face Registration	Local operation: Enroll face with machine, import user photo with U disk Software operation: Import user photo to software, capture user photo with camera
Verification	Dynamic face recognition, password, ID/IC card optional
Face Recognition Accuracy	99.70%
Recognition Speed	≤0.2s, support single user/multi user(at most 5 users) recognition at same time
Recognition Distance	0.5~2.5 meters (0.5~1.5 meters with live face recognition on)
Prevent Photo	Dual camera anti-counterfeiting, prevent recognition with photo/video
Principle of Identification	Face algorithm technology of multi-task cascaded convolutional neural network based on video stream for dynamic face detection, tracking and recognition
WDR	Wide dynamic range, support accurate face recognition under Strong light, dark light and backlight
USB	USB2.0 x 1 , Support U disk import/export data
Power supply	DC12V interface x 1
Speaker Interface	Reserved for extended Speaker Interface
Network Communication	TCP/IP, Support C/S LAN communication, Wifi (optional)
Free Attendance software	Support USB Flash Driver Download for the excel files of detailed temperature detection record and attendance report
Shift	Support shift setting and importing shift schedule with U disk
Management Software	Support PC software to manage data through network connection with equipment
Access Control Function	Door unclosed alarm, forced door opening alarm, alarm linkage and output, one set of door opening signals, one set of alarm signals, time permission control, connect external access control reader, Wiegand 26/34 Output&Input
Environmental adaptability	Working temperature: -15°C~+45°C (storage temperature -40°C~+65°C) , Working humidity: 20%~90% (storage humidity 20%~90±2%) , Dark enviroment: LED Soft light automatic fill light (Automatic control according to ambient light) Ambient light adaptation range: 0-50000Lux
Multi language	English, Spanish, Arabic, Thai, Farsi, Portuguese, French, Italian, Japanese, Korean, etc
Broadcast and ring	Support display name, voice broadcast name, builtin bell ring
Automatic fill light	Support infrared fill light, the white fill light automatically lights up when face is captured in dark light
Working Current	stand-by current: 310mA , Working current: 520mA
QR Code Scanner	Support
Working Voltage	DC12V
Installation Way	Standard: Wall mount, desktop stand; Optional: bracket for turnstile, floor stand

Fingerprint & Card Access Control

Different Case designs for your Option

Face & Fingerprint Access Control and Time Attendance Management Systems



TFS28
2.4" TFT Color LCD
Fingerprint 3000
Size 105*105*30mm



TFS28 Plus
2.4" TFT Color LCD
Fingerprint 3000
Size 105*105*30mm



TFS30
2.4" TFT Color LCD
Fingerprint 3000
Size 190*80*33mm



TFS50
Metallic case
IP65 waterproof
(Optional IP67)
ID&IC card
Slim design: 140*42*18mm,
for door with slim frame



TFS70
2.0" TFT Color LCD
Fingerprint 3000
Size 190*80*33mm



TFS80
2.4" TFT Color LCD
Fingerprint 5000
Size 198*77*33mm



TFS90
2.8" TFT Color LCD
Fingerprint 3000
Size 190*80*42mm



TM68
2.8" TFT Color LCD
Fingerprint 3000
Size 190*80*33mm

Common Features

- ◆ Multiple identification: fingerprint and card together.
- ◆ 500 Dip hidden fingerprint sensor for dry fingerprint and strong sunshine.
- ◆ Wiegand in&out to combine with access controller.
- ◆ Standard TCP/IP, GPRS, RS485, USB for communication with computer and server together.
- ◆ With software management together for time attendance and access control.
- ◆ Lighted keypad for easier operation and using at night.
- ◆ Free SDK and Free software
- ◆ Two door interlock function: A door open, B door closed.

Specifications

Working	Online
Identification Style	Fingerprint, card, password
Identification Speed	<1 sec
FAR	<0.01
FAR	<0.0001
Fingerprint Capacity	3000
Card Capacity	3000
Password Capacity	3000
Record Capacity	200,000
Display	2.4 / 2.8 TFT Color Screen
Language	English/Spanish/Turkish/Arabic/Thai/Persian and so on
Communication	TCP/IP/USB
Humidity	20%-60%
Temperature	0°C-40°C
Access control	Simple access control function for door open/close control
Output	Electric Lock
Voice	Boom, Dual LED
Power Supply	DC12V
Software	Free

Fingerprint & Card Time Attendance

Different Case designs for your Option

Face & Fingerprint Access Control and Time Attendance Management Systems



TM52



TM20



TM30



TM50



TM51



TM58



TM60



TM70



TM88



TM90



TM1000



TPAD86

Common Features

- ◆ Special algorithm with faster speed and high steady quality.
- ◆ High USB interface with 10 times speed than normal usb.
- ◆ With international 32 bit DSP CPU.
- ◆ High resolution LCD show employee's name and finger image.
- ◆ 3000/5000 fingerprints suits different enterprise and company.
- ◆ High speed tcp/ip communication make data transfer steady.
- ◆ Free driver scan usb for easy using.
- ◆ USB pen driver download or upload the reports in Excel or TXT file
- ◆ Provide free software and free sdk.

Specifications

Working	Online
Identification Style	Fingerprint, card, password
Identification Speed	<1 sec
FAR	<0.01
FAR	<0.0001
Fingerprint Capacity	3000
Card Capacity	3000
Password Capacity	3000
Record Capacity	200,000
Display	2.4 / 2.8 TFT Color Screen
Language	English/Spanish/Turkish/Arabic/Thai/Persian and so on
Communication	TCP/IP/USB
Humidity	20%-60%
Temperature	0°C-40°C
Access control	Simple access control function for door open/close control
Output	Electric Lock
Voice	Boom, Dual LED
Power Supply	DC9V
Software	Free

Fingerprint & Card Standalone Time Attendance



TFS-10 TFS-12A TFS-16 TM-1800 TM-2800 TM-3800 TM-4800 TM-5800 TM-8000

Different Case designs for your Option

Face & Fingerprint Access Control and Time Attendance Management Systems

Common Features

Attendance Shift Setting:

- ◆ As days, weeks, months to set the attendance
- ◆ Support work in&out, relay, overtime setting
- ◆ Support holiday, weekend and leaving setting
- ◆ Support retroactive setting

Color LCD

- ◆ High resolution ratio LCD shows employee name, fingerprint image

Employee information register

- ◆ T9 input too register the employee name in the attendance device
- ◆ USB pen drive to download or upload the employee's details

USB Pen driver store data

- ◆ USB pen driver download or upload the reports in Excel or TXT file
- ◆ USB Pen driver download or upload employee details for easy editing
- ◆ USB Pen driver download or upload attendance shift setting

Attendance Exports

- ◆ Auto generate reports in Excel or TXT file
- ◆ Both raw data and statistic data reports

Specifications

Working	Standalone
Identification Style	Fingerprint, card, password
Identification Speed	<0.8 sec
FAR	<0.01
FAR	<0.0001
Fingerprint Capacity	1000
Card Capacity	1000
Password Capacity	1000
Record Capacity	100,000
Display	2.4 / 2.8 TFT Color Screen
Language	English/Spanish/Turkish/Arabic/Thai/French/Vietnamese and so on
Communication	FP+Card, PIN+Card,FP+PIN, FP+PIN+Card
Humidity	20%-60%
Temperature	0°C-40°C
Reports	USB pen driver download reports in Excel or TXT file
Name Display	1-16 digital
Voice Promote	Late or leave early voice promote
Power Supply	DC5V
Software	Free

Multi Two/Four Doors Access Controller System

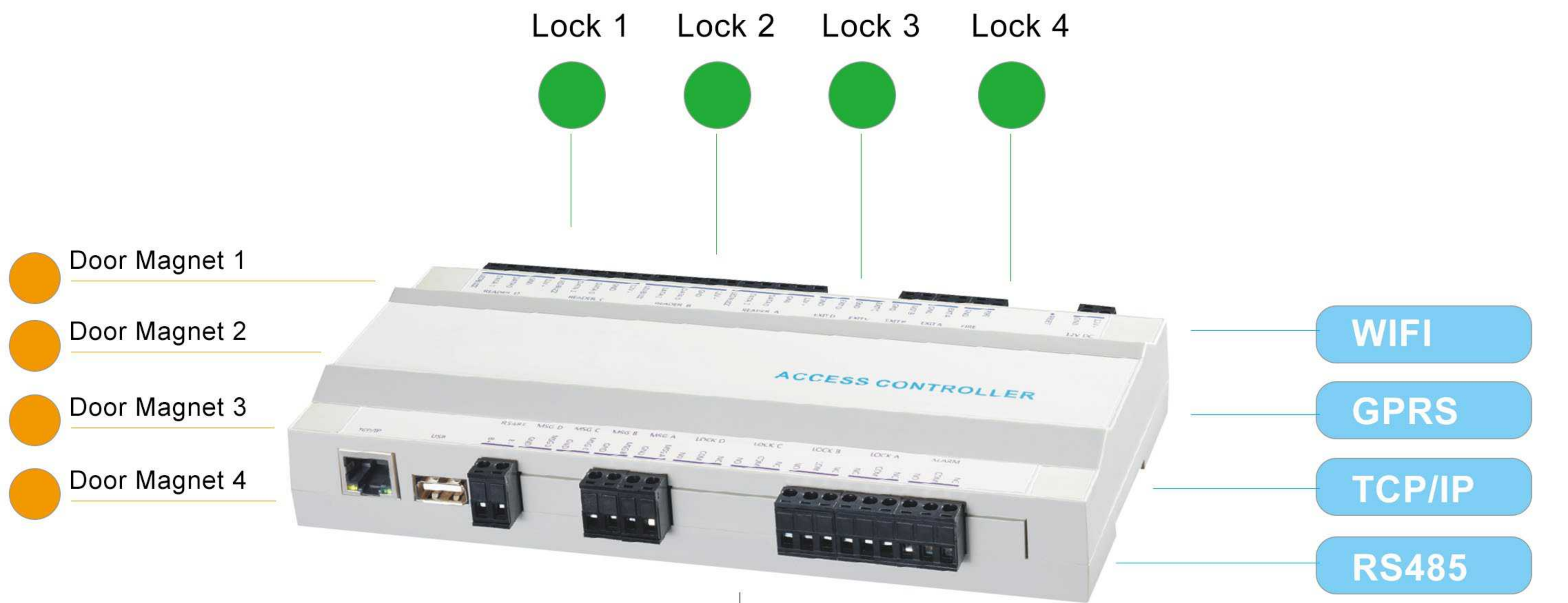

5~20meters long range UHF Reader



QR Code reader



QR Code reader



RFID card reader



All in one solution

Intelligent channel management system



TM-L229
Size: 500*280*960mm



TM-L129
Size: 1000*230*960mm



TM-LV129
Size: 480*230*960mm



TM-LV329
Size: 480*280*960mm



Card access control / reader



TDS19EM-W/MF-W

Waterproof Access Control / Reader

- ◆ Card Capacity: 2000
- ◆ Size: 86*86*20mm
- ◆ Verify Mode: PIN , ID Card, Pin+ID Card (Optional IC)



TDS10EM-W/MF-W

Waterproof Access Control / Reader

- ◆ Card Capacity: 2000
- ◆ Size: 225*115*75mm
- ◆ Verify Mode: PIN , ID Card, Pin+ID Card (Optional IC)



TDS13

Waterproof Access Control / Reader

- ◆ Card Capacity: 3000
- ◆ Size: 108*76.6*20mm
- ◆ Verify Mode: PIN , ID Card, Pin+ID Card



TDS16

Touch Screen Access Control / Reader

- ◆ Card Capacity: 3000
- ◆ Size: 78.7*78.7*18.6mm
- ◆ Verify Mode: PIN , ID Card, Pin+ID Card (Optional IC)



TDS12

Waterproof Access Control / Reader

- ◆ Card Capacity: 3000
- ◆ Size: 160*43*21mm
- ◆ Verify Mode: PIN , ID Card, Pin+ID Card (Optional IC)



TDS18



TDS19

Card Access Control

- ◆ Card Capacity: 800
- ◆ Size: 110*60*20(mm)---TDS18 113*60*17mm----TDS19
- ◆ Verify Mode: Pin , ID Card, Pin+ID Card (Optional IC)



Locks & Access Control Power Supply

Product Appearance					
Model	TM-205 Electric lock	TM-208LED Magnetic Lock	TM-205W Door holder	TM-280-ZL	TM-280-U
Feature	<ul style="list-style-type: none"> ◆ Lower temperature electric lock ◆ Dimension: 200Lx34Wx42H 	<ul style="list-style-type: none"> ◆ 280KG single door with light magnetic lock with single out ◆ Dimension: 250Lx43Wx26H 	stainless steel door handle for metal and glass door	L-Shape, Z-shape bracket for 280KG magnetic lock	Magnetic lock , U-shape bracket for without drilling on rimless glass door

Product Appearance				
Model	TM-20	TM-21	TM-5A Power supply	TM-JX Power supply
Feature	Aluminum alloy door holder for installation on rimless glass door	Stainless steel door holder for small gap between door frame and door	Output 12V, Dual gauge voltage regulator, Standard pure Copper transformer, Push input and Electric lock output	<ul style="list-style-type: none"> ◆ Power : 30-50W ◆ Input voltage : AC220V or AC110V ◆ Output voltage : 12VDC ◆ Rated current : 3A ◆ External battery specification : 7AH 12VDC ◆ Battery Over discharge voltage : 9V

Exit Buttons

Product Appearance	 ◆Dimension : 91x28	 ◆Dimension : 80x30x24	 ◆Dimension : 86x50x20	 ◆Dimension : 86x86x20
Model	TM-01A Exit button	TM-01C Zinc Alloy Exit button	TM-02A Infrared Exit button	TM-04B Lighted exit button

Product Appearance	 ◆Dimension : 86x86x25	 ◆Dimension : 86x86x20	 ◆Dimension : 86x86x50
Model	TM-05A Exit button	TM-06A Infrared Exit button	TM-07W Emergency door release

MUTE ELECTRONIC LOCK

SMART FINGERPRINT INTEGRATED LOCK

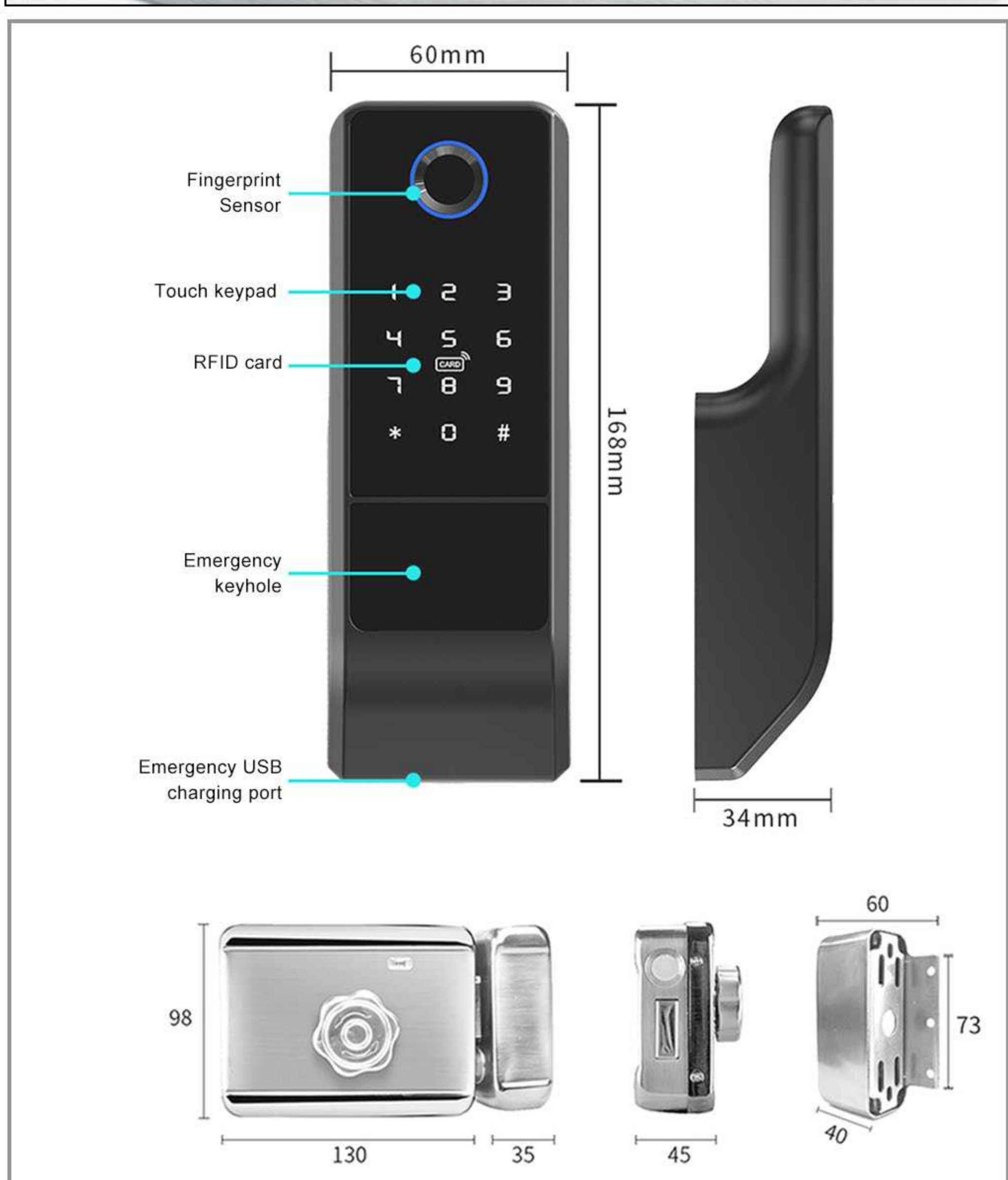

Parameters

Capacitive Fingerprint Sensor	< 4.5s
Fingerprint capacity	100
battery life	80,000 times normal unlock
FAR	< 0.001 (%)
FRR	< 0.001 (%)
Communciation	Wifi
Fingerprint sensor	Capacitive
Working temperature	-20°C ~ 60°C
Operating humidity	0 ~ 90 (%)
Material	Aluminum alloy
Available color	Black
Power supply	4pcs 5AA battery, USB charging port for emergency
Mechanical key	Support
Tuya APP	support iphone and Android phone
Unlock way	Mobile APP +Fingerprint + Password + Card + Key
Door Type	Wood door, Steel door,for house/office/apartment use

Amazon Hot Sale

Low Power Consumption Intruder Motion Detection Wifi Camera & Door Bell



Alarm Push Notification Motion Detection

When camera detects any motion in surveillance area, app will receive a push notification from the camera



IP66 Waterproof



Motion Detection



Low Power



Night Vision

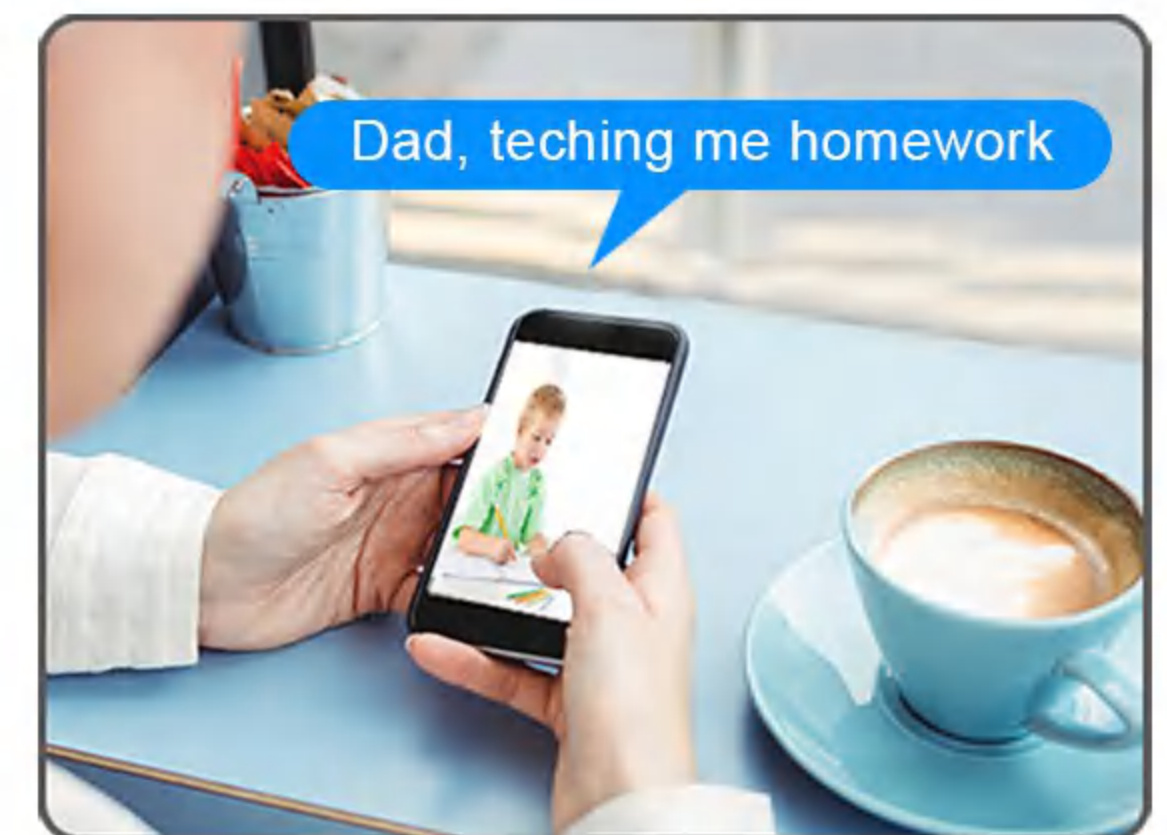
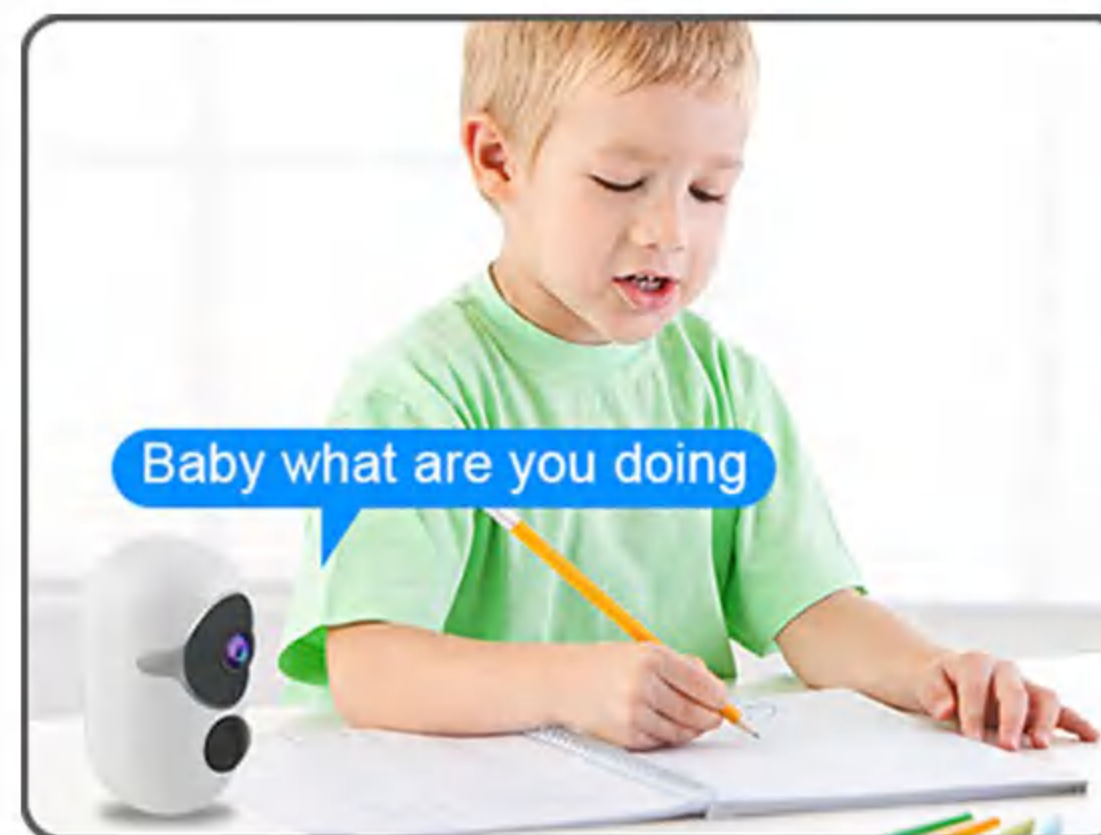
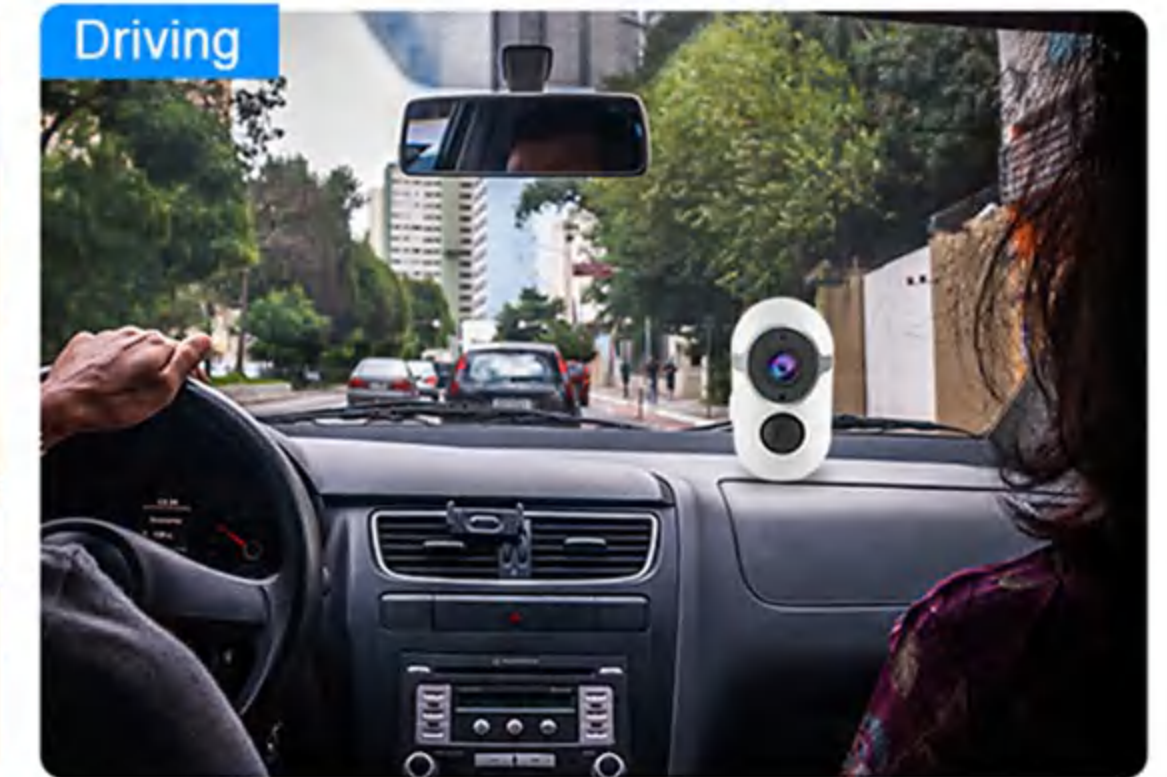

Real Time Message Push

Voice Calls Two Way Audio



Wifi-2.4Ghz



PIR Motion Detection



High-Definition



Mobile Phone Remote



Infrared Night Vision



Solar LED Street Light

- Support human body induction
- All In One Solar Street Light
- Charging during the day, automatic light at night without operation, intelligent response to all weather changes
- High light efficiency
- High efficiency polysilicon solar panel. Solar panel with PET lamination process, high conversion, fast charging, durable and long lasting



Motion Sensor



Solar Panels



Li-ion Battery



IP65 Waterproof



Solar LED Wall Lamp

- Support Waterproof IP 65
- Support charging during the day, automatic light at night without operation



Solar charge



Rainy day



Light sensor mode



Motion sensor



Waterproof IP65



LED Sensor Night Lamp

- Support dual Induction, light sensor+infrared human body induction
- Light goes with you wherever you go



Appearance design patent



Real manufacturer



Light control infrared sensor



Emergency flashlight



USB charging

201730094698.2