

CNCOB® User's Manual

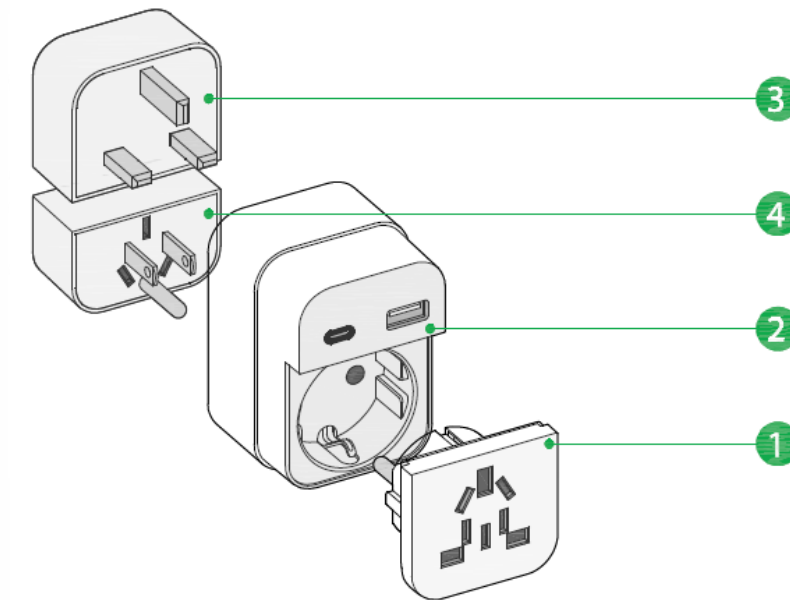

Universal travel plug converter

Thank you for choosing our company's products. Please read this manual carefully before using the product.
This manual applies to the following product models:

Model:	Description
CN-TL2025/W(white)	Universal travel plug converter with Dual USB Ports
CN-TL2025/B(black)	Universal travel plug converter with Dual USB Ports

Model

CN-TL2025/W(white)

CN-TL2025/B(black)

(suffix indicates color variant and regional market)



Module

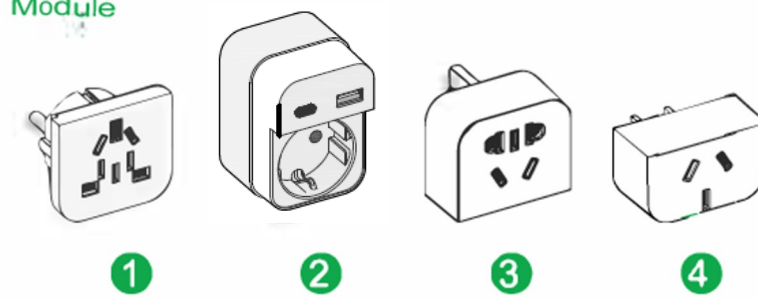

Important Safety Instructions

- 1.Ensure your hands are dry before using this socket.
- 2.This socket is designed solely for converting between plugs of different national standards and does not have voltage conversion functionality. Please confirm that your device is compatible with the rated voltage/current specified above.
- 3.Before charging with this charging socket, ensure the battery of the device to be charged complies with charging specifications.
- 4.Do not simultaneously connect two or more plugs to this socket.
- 5.Avoid inserting small metallic objects (e.g., paper clips) into the charging port of this socket.
- 6.The charging socket may feel slightly warm during use—this is not an abnormal occurrence.
- 7.Do not insert one converter into another converter
- 8.When cleaning, first disconnect the power supply. Wipe the surface with a slightly damp soft cloth or tissue to remove dust and dirt. Do not use corrosive chemicals such as alkaline detergents, acidic detergents, thinners, gasoline, insecticides, etc., as they may cause surface cracking or malfunctions.

Product Specifications

Rated volage/current	: 250V~/10A
Input voltage/current	: 250V~/10A
Input frequency	: 50/60Hz
Socket output voltage/current	: 250V~/10A
USB output voltage	: 5V DC
USB output Current	: 2.1A max total 2.1A
Overall dimension	: 74.2x52.2 x75 mm
Safety Standards	: EN IEC 62368-1:2024 EN 55032:2015+A11:2020+A1:2020 (Class B) EN 55035:2017+A11:2020 EN IEC 61000-3-2:2019+A1:2021 EN 61000-3-3:2013+A1:2019+A2:2021

Electrical Parameters

Module	Input voltage/current	Output voltage/current
1	250VAC/10A	250VAC/10A
2	250VAC/10A	250VAC/10A
3	250VAC/10A	250VAC/10A
4	250VAC/10A	250VAC/10A

USB

Module	Input voltage/current	Output voltage/current
2	110-250VAC/10A	5VDC/Max 2.1A

This product has passed qualification check.



Guangdong Quansheng Electrical Co., Ltd.
Address: Room 701, Building 3, No. 9,Wanjiang Innovation Road,Wanjiang Street, Dongguan City,Guangdong Province
Phone: 0755-28138611 (10 extensions) Toll-free Service Hotline: 400-879-8796

REV 01

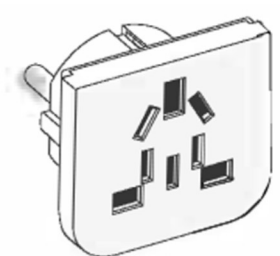

Compatible for standalone use in most European countries including Germany, France, and Russia.

B

UK standard regions, such as the UK, Hong Kong China, Macao China, Singapore, Malaysia, etc., can be used independently 3.

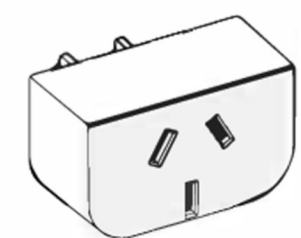

US standard regions, such as the US, Taiwan region, Japan, etc., can be used independently with adapter 4.

D

Australia, New Zealand, Argentina, etc., can use Adapters 1 and 2 to convert two-pin plugs.

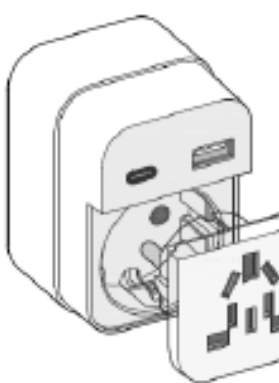

China, Australia, Argentina, etc., can use Adapters 1 and 2 for conversion.

B

Most European countries, such as Germany, France, Russia, etc., can use Adapter 1 independently.

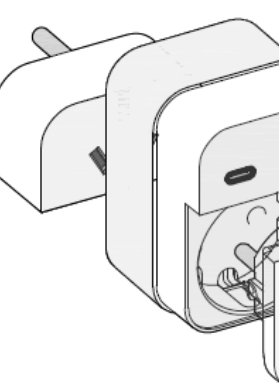

US standard regions, such as the US, Taiwan region, Japan, etc., can use Adapters 1, 2, and 4 for conversion.

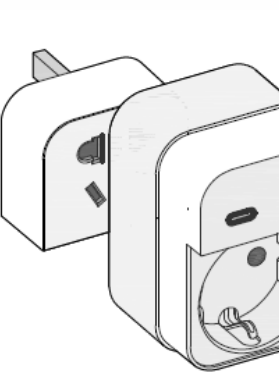

UK standard regions, such as the UK, Hong Kong China, Macao China, Singapore, Malaysia, etc., can use Adapters 2 and 3 for conversion.

B

US standard regions, such as the US, Taiwan region, Japan, etc., can use adapters 2 and 4 for conversion.

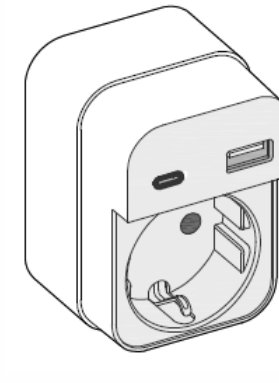

China, Australia, Argentina etc., can use adaptor 2 independently.



USB Charging Guide

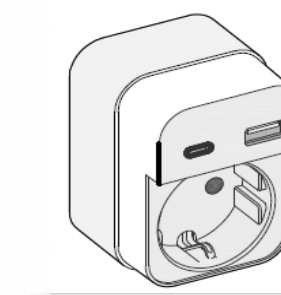

For China, Australia, Argentina, etc. Use Port 2 for USB charging.

B

For UK Standard Regions (UK, Hong Kong China, Macao China, Singapore, Malaysia, etc. Use Ports 2 & 3 for USB charging

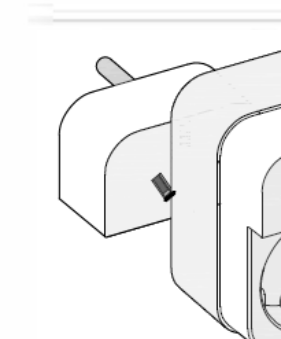

For US Standard Regions (USA, Taiwan region, Japan, etc. Use Ports 2 & 4 for USB charging.

D

For European Countries (Germany, France, Russia, etc. Use Ports 2 & 1 for USB charging.